



# C&I PowerHill DuLink APP

## User Manual

## Notice

This manual contains important safety instructions, installation, electrical connections, commissioning, maintenance, and troubleshooting of the equipment.

## Save the manual!

This manual must be stored carefully and be available at all times.

## Copyright Declaration

All rights to the content of this manual are owned by Dunext Technology Suzhou Co., Ltd. (hereinafter called as 'Dunext'). Any corporation or individual should not plagiarize, partially or fully copy it, and reproduce or distribute it in any form or means without prior written permission from Dunext.

Dunext reserves the right of final interpretation. This manual may be updated according to user's or customer's feedback. The information in this manual is subject to change without notice. Every effort has been made to ensure the accuracy of the contents of this manual, but nothing mentioned herein expresses or implies any other information.

Please check our website at <http://www.dunext.com> for latest version.

# Contents

<b>About This Manual .....</b>	<b>III</b>
<b>1 Account and Security.....</b>	<b>4</b>
1.1 Create Account .....	4
1.2 Login.....	5
1.3 Retrieve Password .....	6
<b>2 C&amp;I PowerHill Plant.....</b>	<b>8</b>
2.1 Overview .....	9
2.1.1 Overview .....	9
2.1.2 Statistics.....	10
2.2 Device.....	10
2.3 Settings.....	11
2.4 Alarm .....	12
2.5 Create Plant .....	12
2.6 Plant Info.....	14

# About This Manual

---

## Overview

Please read the manual carefully before performing any operations on the C&I PowerHill DuLink app. This manual contains common operations on the app.

## Intended Audience

This manual is intended for installers and distributors of C&I PowerHill DuLink app.

## Change History

Changes between document issues are cumulative. The latest document issue contains all the changes made in earlier issues.

### Issue 01 (2025-08-22)

This issue is used for first application

## Quick Links to Commonly-Used Functions

- **Common Functions**
  - [Create Account](#)
  - [Login](#)
  - Create Plant
  - [Plant Info.](#)
- **C&I PowerHill Plant**
  - [Overview](#)
  - [Statistics](#)
  - [Device](#)
  - [Alarm](#)
  - [Settings](#)

# 1 Account and Security

## 1.1 Create Account

### Before You Start:

Check if your company already has a DuLink account.

- If yes: Request account setup from your company administrator.
- If no: Follow the procedure below to register as an Administrator.

### Procedure:

1. On the login page, click **Register**.
2. Select **Installer/Distributor** as your role.

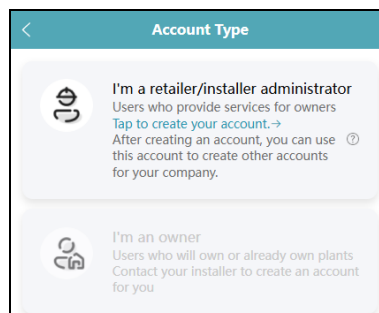

3. Enter required details, agree to **Terms of Use** and **Privacy Policy**, then click **Register**.

## 1.2 Login

1. Select the language as required.
2. Enter **username/email** and **password**.
3. Agree to ***User Terms*** and ***Privacy Policy***.
4. Click **Login**.

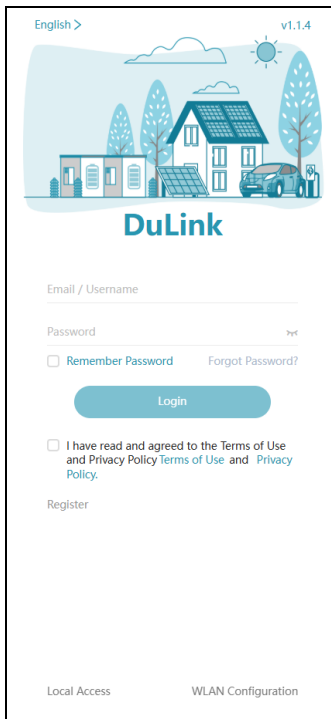

English > v1.1.4

**DuLink**

Email / Username

Password

☐ Remember Password [Forgot Password?](#)

Login

☐ I have read and agreed to the Terms of Use and Privacy Policy Terms of Use and Privacy Policy.

[Register](#)

Local Access WLAN Configuration

## 1.3 Retrieve Password

### Procedure:

1. Click **Forgot Password** on the login page.

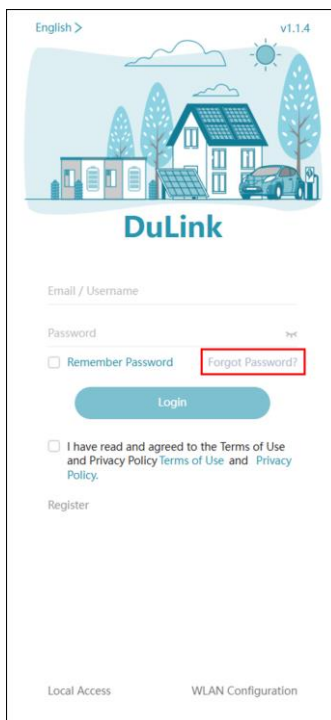

English > v1.1.4

**DuLink**

Email / Username

Password

☐ Remember Password [Forgot Password?](#)

Login

☐ I have read and agreed to the Terms of Use and Privacy Policy Terms of Use and Privacy Policy.

[Register](#)

Local Access WLAN Configuration

2. Follow the email instructions to set a new password.

<

Retrieve Password

\* Email

Please Enter

\* Verification Code

Please Enter

Send

\* Password

Please Enter

hyt

\* Repeat Password

Please Enter

hyt

Submit



# 2

## C&I PowerHill Plant

On the Plants page, you can view the information of multiple plants and the plant list under the current account.

Each plant can be in one of three states:

- Normal: All devices are operating properly.
- Offline: At least one device is disconnected from DuLink.
- Faulty: Abnormality or serious fault occurs to the device, requiring immediate attention.



### Details of C&I PowerHill Plant

Click any plant on the Plants page to access detailed information, including Overview, Device, and Settings.

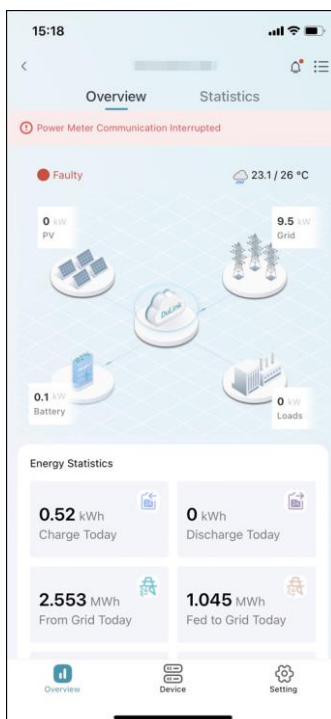

## 2.1 Overview

The Overview consists of two submenus: Overview and Statistics.

### 2.1.1 Overview

It displays plant data to help you monitor and analyse plant performance.

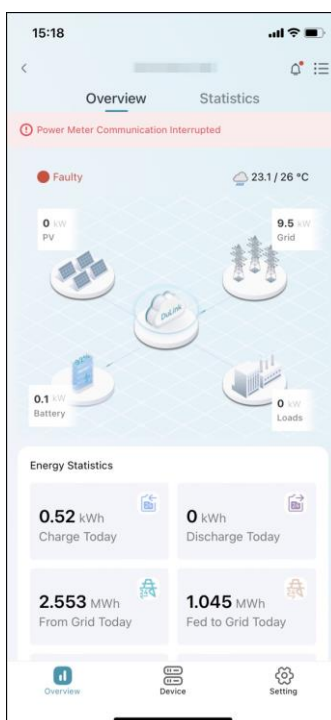

## 2.1.2 Statistics

It displays the energy, power and revenue statistics of the plant.

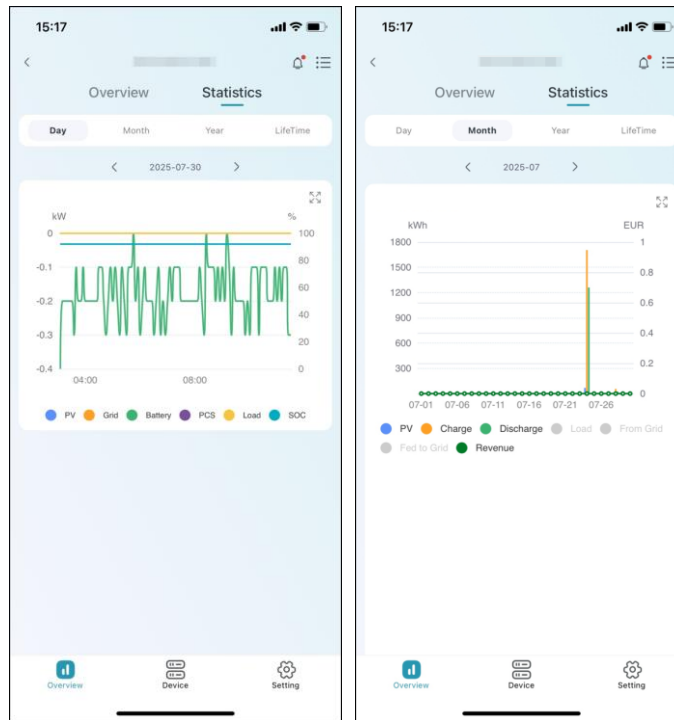

## 2.2 Device

It displays all device information for the power plant. Click any device in the list to view its real-time operational data.

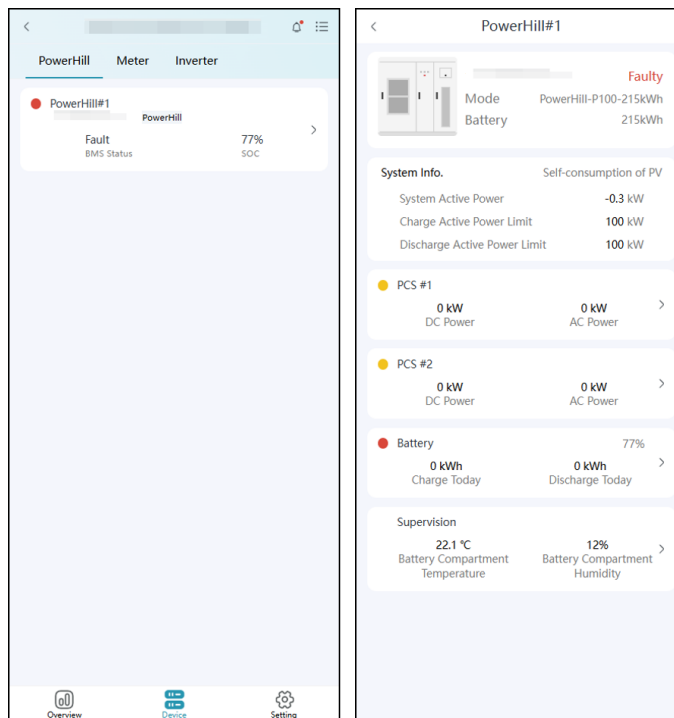

## 2.3 Settings

You can remotely set parameters for the plant here, including: Start/Stop, Grid Import Power, Grid Export Power, SOC Limits, Work Mode, etc.

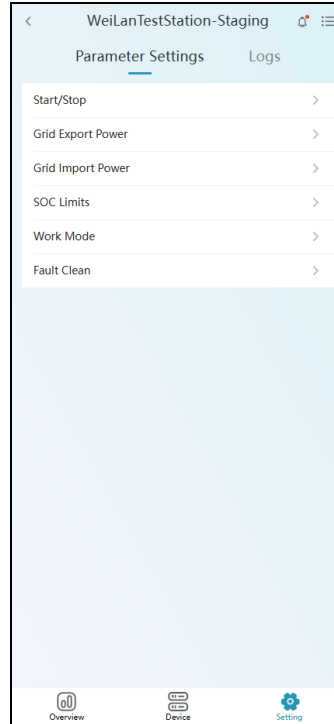

Click Logs and you can view the complete history of all remote configuration changes.

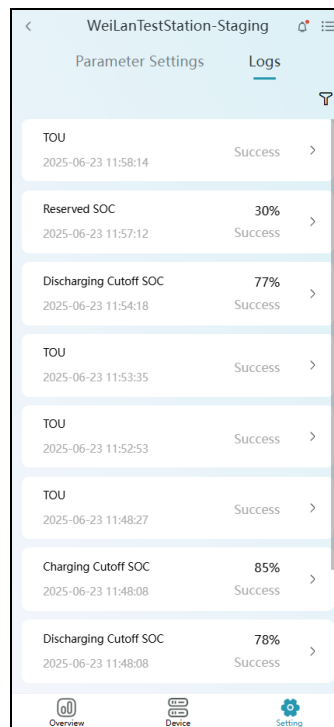

## 2.4 Alarm

Click the alarm icon in the upper-right corner of the plants overview page to view plant alarm information, including active alarms and history alarms.

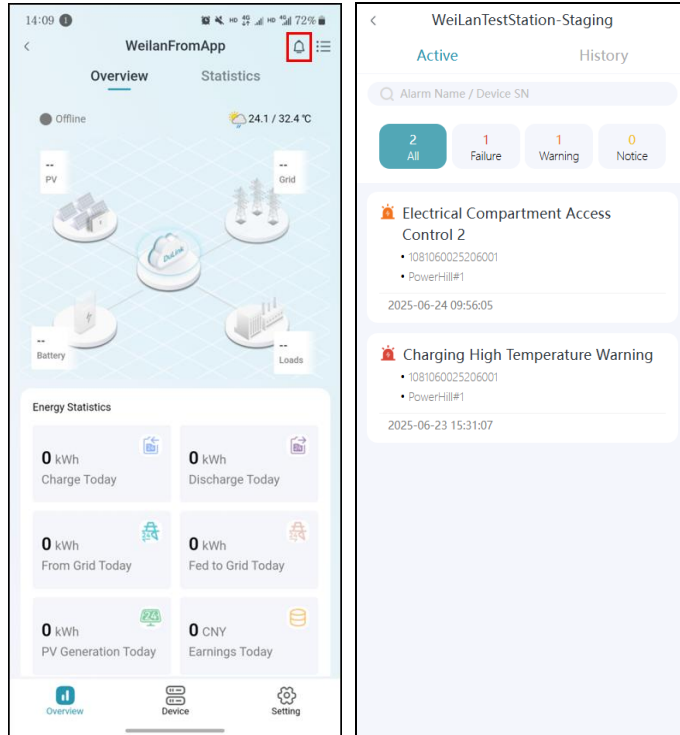

## 2.5 Create Plant

Click Create Plant or  on the homepage, and select the plant type: **C&I PowerHill**, and complete the following steps:

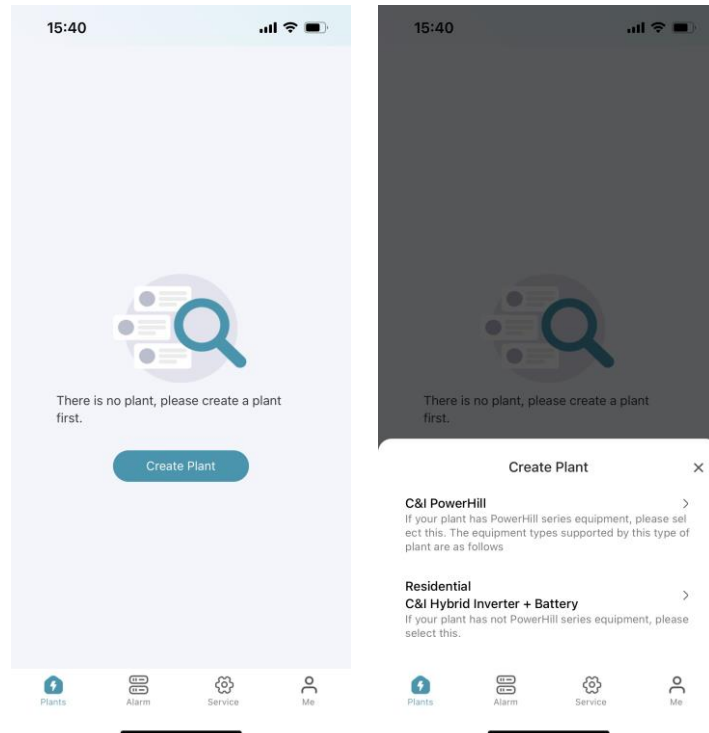

**Step 1:** Fill in the basic information, including plant category, plant name, detail plant address, plant time zone, PV capacity, currency, etc.

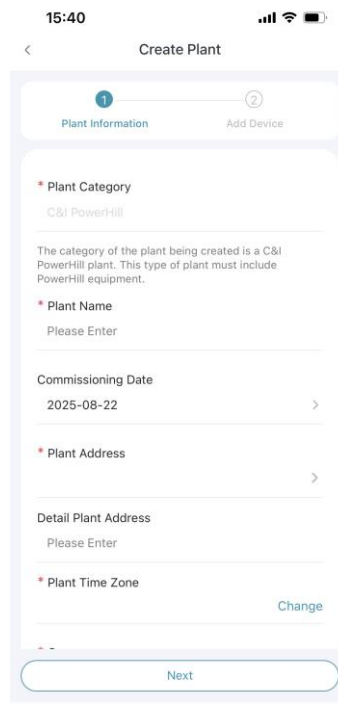

**Step 2:** Select Device Type (PowerHill shall be added first), then manually enter the device serial number to add device.

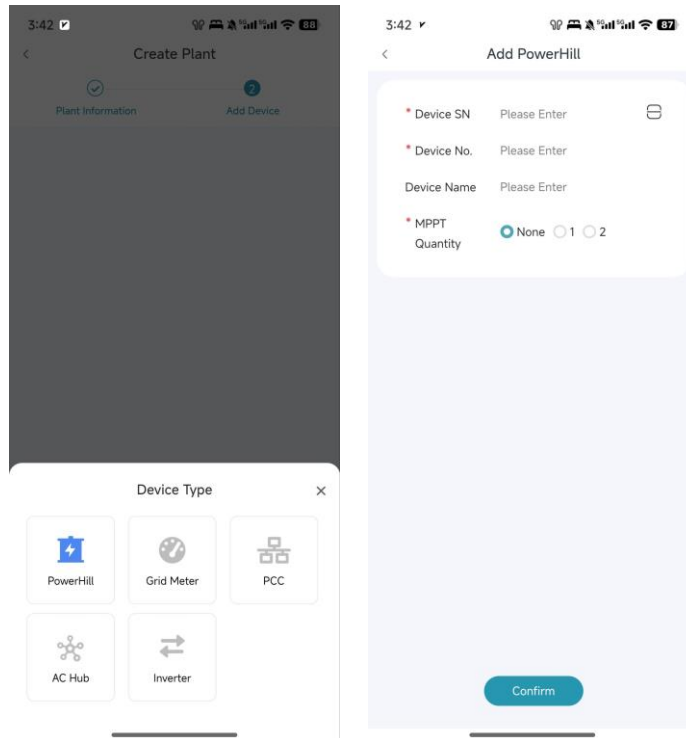

**Step 3:** Click **Submit** to complete. The new plant will appear in the plant list.

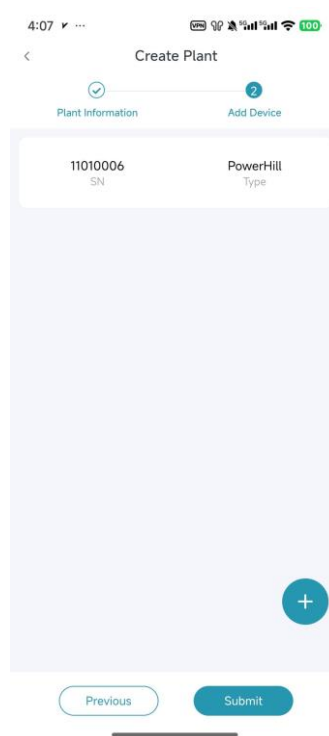

## 2.6 Plant Info.

Click the plant info. icon in the upper-right corner of the plants overview page to manage plant information, including: Basic Information, User Information, Tariff Information, and Plant Number.

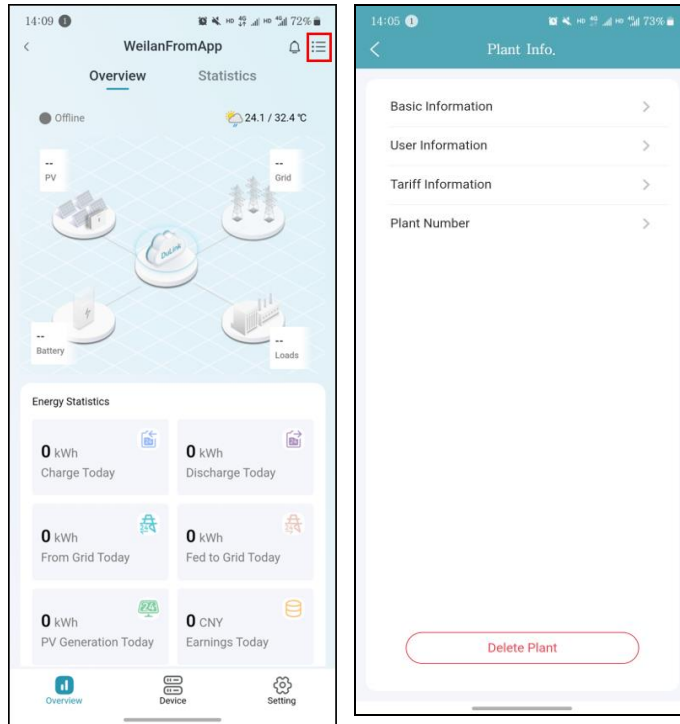

### Basic Information

It allows you to edit the basic information of the plant.

### User Information

It enables you to manage the end user information of the plant.

### Tariff Information

It enables you to set the feed-in tariff and purchase price.

### Plant Number

The plant number can be edited to ensure synchronization with the EMS system





Innovate for a Green Future

**Dunext Technology Suzhou Co., Ltd.**

✉ [service@dunext.com](mailto:service@dunext.com)

🌐 [www.dunext.com](http://www.dunext.com)